



Quiet Power™

FS20-H20 series

Liquid cooled case

Quick installation guide

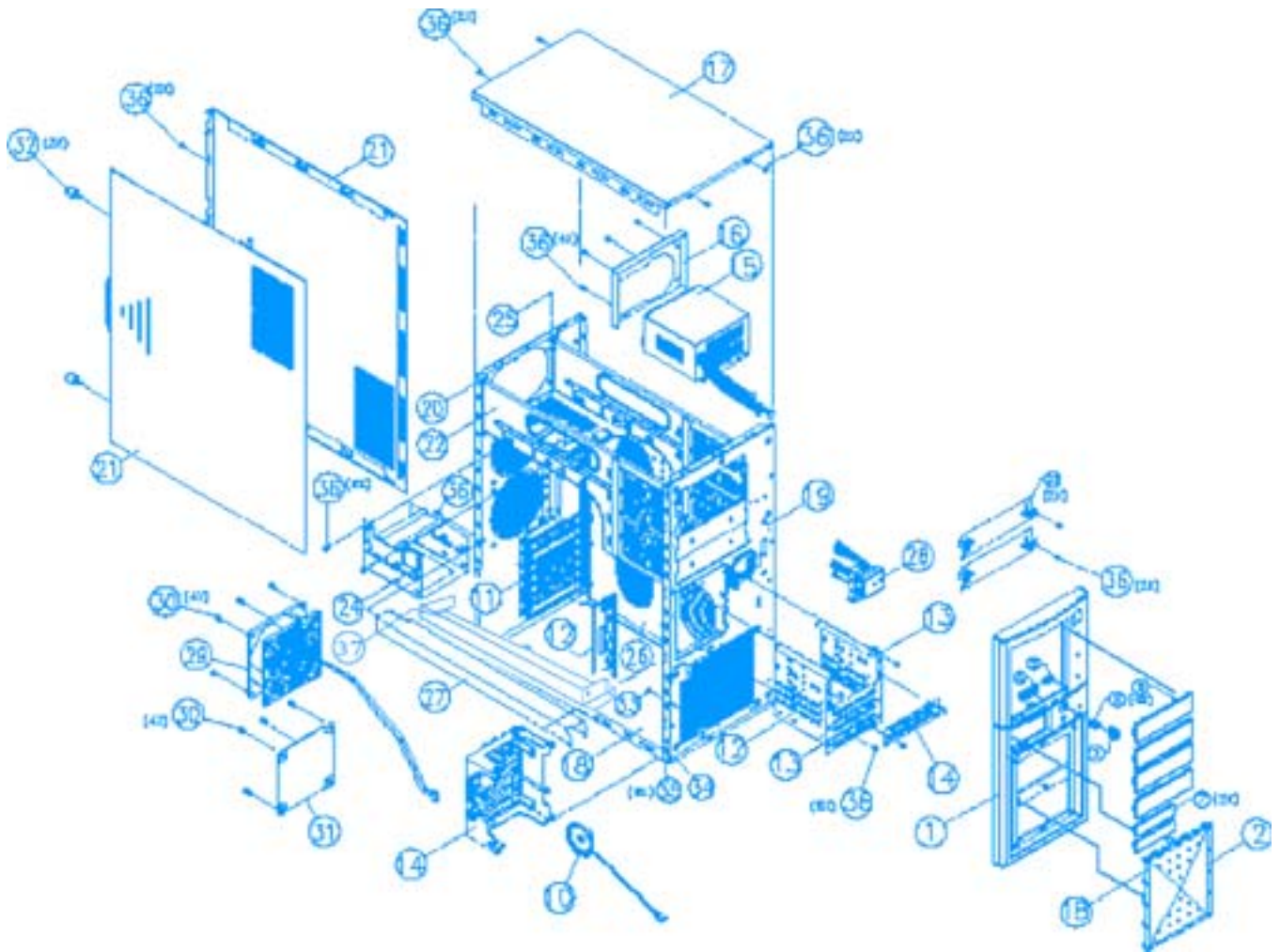



NO	PARTS	PS
1	BEZEL, FRONT	1
2	BEZEL, FRONT, SUB	1
3	BUTTON, POWER	1
4	BUTTON, RESET	1
5	LENS	1
6	COVER, 5.25 FDD	4
7	COVER, 3.5 FDD	2
8	SPRING	1
9	PLATE, CAGE, 5.25	2
10	SPEAKER	1
11	BULKHEAD ASSY	1
12	SHIELD, I/O	1
13	CAGE, 3.5 ASSY	1
14	CARDGUIDE	1
15	POWER SUPPLY	1
16	BRACKET, P/S	1
17	COVER, TOP	1
18	CHASSIS, BOTTOM	1
19	PANEL, FRONT	1
20	PANEL, REAR	1
21	SIDE, PANEL	2
22	CAGE, 5.25	1
23	FILLER TOP 3.5	1
24	BRACKET, HDD	1
25	SLIDE BRACKET P/S	1
26	BASE, M/B	1
27	CROSS BAR	1
28	BRACKET, LED ASSY	1
29	FAN 120MM	1
30	SNAP RIVET	8
31	SHIELD	1
32	THUMB SCREW	2
33	SCREW	1
34	RIVET, ALUMINUM	49
35	RIVET-SUS	8
36	SCREW	20
37	MEMORY BOARD CROSS BAR	1

Components installation

1. Open the side-panel #21 by loosening thumb screws #32
2. Remove the main cross bar #27, and the memory board cross bar #37 (discard #37 bar if not needed)
3. Loosen screw #33, and remove the front bezel #1
4. Remove the top cover #17

You now have full access inside the case to proceed with the installation of your power-supply, motherboard, hard drive (s) and various components.

Liquid cooling circuit notes

- The water-block is installed onto the back-panel for safe shipping. Unscrew the 4 springs assemblies, and remove the four aluminum standoffs used to secure the block to the back-panel. *You will need these standoffs later, together with the spring and screw assemblies to install the water-block onto your motherboard.*
- During installation of your motherboard inside the case, it is good practice to strap the block out of the way, using a rubber band for example.
- *Your cooling circuit is already filled with liquid (75% pure water, 25% antifreeze). All you need to do is to install the water-block to your CPU (follow separate instructions for AMD® or INTEL® processors).*
- Power to the pump: a spare power cord is provided to supply A/C power to the pump. *It needs to be connected to an A/C outlet.*